

LEGEND

S.NO	DESCRIPTION	SYMBOL
1.	5 AMP. ONE-WAY SWITCH WITH REGULATOR (AT 1100 MM F.F.L.)	
2.	16 AMP. ONE-WAY SWITCH FOR GEYSER (AT 1100 MM F.F.L.)	
3.	16 AMP. ONE-WAY SWITCH FOR GEYSER IN KITCHEN (ABOVE COUNTER)	
4.	5 AMP. ONE-WAY SWITCH FOR AQUAGUARD (ABOVE COUNTER)	
5.	1 X 20 WATT LED TUBE LIGHT (CEILING MOUNTED)	
6.	20W LED TUBE LIGHT (WALL MOUNTED) (2150MM(minimum) FROM F.F.L.)	
7.	1x9W LED LIGHT (CEILING MOUNTED)	
8.	1x12W LED LIGHT (CEILING MOUNTED)	
9.	BRACKET LIGHT (WALL MOUNTED) (2150MM(minimum) FROM F.F.L.)	
10.	CEILING FAN	
11.	BULK HEAD LIGHT (AT 2200 MM F.F.L.)	
12.	EXHAUST FAN	
13.	CALL BELL PUSH (AT 1100 MM F.F.L.)	
14.	CALL BELL BUZZER (AT 2150 MM F.F.L.)	
15.	CEILING ROSE (AT 2150 MM F.F.L.)	
16.	6 AMP. OUTLET WITH SWITCH (AT 450 MM F.F.L.) (ABOVE SKIRT LEVEL)	
17.	2NO. 6 AMP. OUTLET WITH SWITCH FOR TV (AT 450 MM F.F.L.)	
18.	16 AMP/6 PIN OUTLET WITH SWITCH (AT 300 MM F.F.L.)	
19.	6 AMP. OUTLET WITHOUT SWITCH FOR AQUAGUARD (BELOW COUNTER LEVEL)	
20.	TV OUTLET (AT 450 MM F.F.L.) (ABOVE SKIRT LEVEL)	
21.	TELEPHONE OUTLET (AT 450 MM F.F.L.) (ABOVE SKIRT LEVEL)	
22.	16 AMP/6 PIN OUTLET WITHOUT SWITCH FOR GEYSER (AT ABOVE 800 MM FROM COUNTER LEVEL)	
23.	16 AMP/6 PIN OUTLET WITHOUT SWITCH FOR GEYSER (AT 1850 MM F.F.L.) ABOVE TILE LEVEL, AWAY FROM SHOWER AREA.	
24.	6 AMP OUTLET WITHOUT SWITCH FOR CHIMNEY(SWITCH IN SWITCH BOARD)	
25.	16 AMP/6 PIN OUTLET WITH SWITCH (AT 300 MM F.F.L.)	
26.	DATA OUTLET (AT 450 MM F.F.L.)	
27.	DISTRIBUTION BOARD (TOP OF 1800 MM ABOVE F.F.L.)	
28.	LOOP SOUNDER HOOTER	
29.	MANUAL CALL POINT	

NOTE-

- 1) 5A S/S WITH SWITCH BOARD SHALL BE 1100MM FFL.
- 2) POWER POINT IN KITCHEN SHALL BE 200MM ABOVE SLAB OR AS PER FURNITURE.
- 3) LOCATION OF ELECTRICAL POINTS SHALL BE CHANGED AS PER FURNITURE / BEAM LAYOUT.

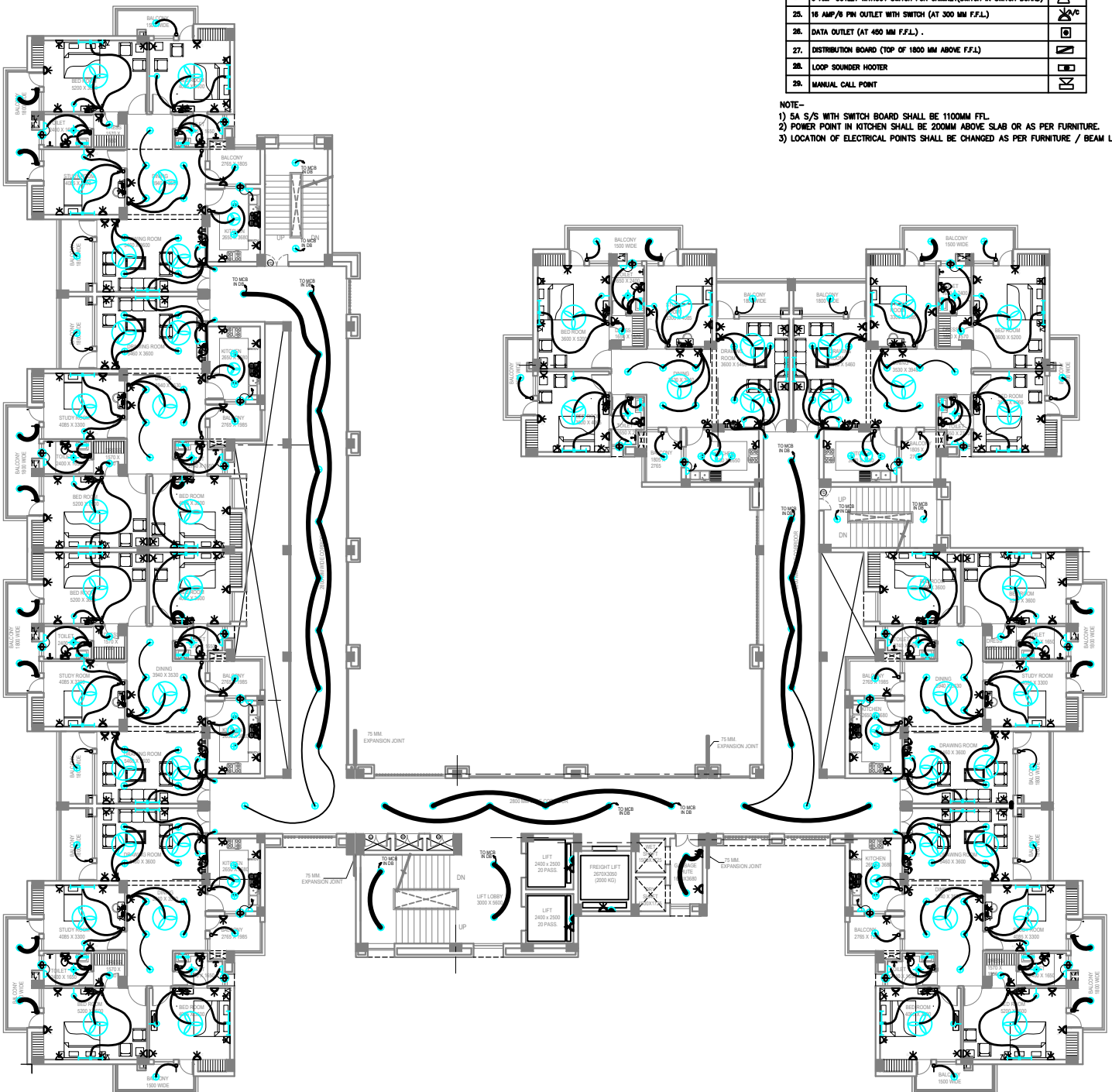

PROJECT:
PROPOSED TYPE-III HOUSING AT I.I.T. KANPUR

NOTES:
 1- ALL DIMENSIONS IN MILLIMETER UNLESS OTHERWISE SPECIFIED.
 2- FIGURE DIMENSIONS SHALL BE FOLLOWED.
 3- ALL DIMENSIONS SHALL BE CHECKED & VERIFIED BEFORE COMMENCEMENT OF THE WORK.
 4- DISCREPANCY, IF ANY, SHALL BE BROUGHT TO THE NOTICE OF ARCHITECT IN-CHARGE AND CLARIFICATION OBTAINED IN WRITING PRIOR TO EXECUTION OF THE WORK.

DRG. TITLE:
 ELECTRICAL LAYOUT PLAN
 FIFTH FLOOR PLAN

BUILDING: BLOCK-02

CLIENT: I.I.T. KANPUR

DRAWING STATUS:
 TENDER DRAWING

DATE: APRIL -2019

SCALE: 1:100 @ A1

DRG. NO.: AED/IIT/WD/BLOCK-02/EL-04

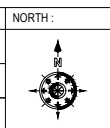

CONSULTING ARCHITECTS:

ARCH-EN DESIGN
 ARCHITECTS
 402/403, 4TH FLOOR, KUMHAR
 COLONY, KANPUR - 208002
 U.P. INDIA
 CONTACT: 9839628888, 9839628889

